

Weller®



사용 설명서

WTSF 80

WTSF 120

WXSf 120

Included in delivery

공급 품목

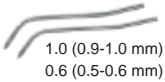
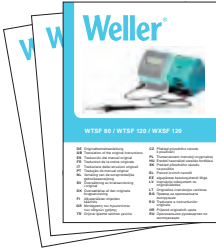

0.8 (0.7-0.8 mm)

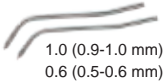

0.8 (0.7-0.8 mm)

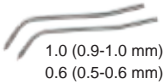

0.8 (0.7-0.8 mm)



Accessory 액세서리

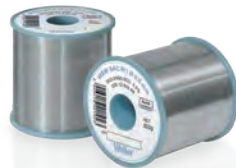

Ø	WSW SAC M1	WSW SAC L0	WSW SC L0	WSW SC M1
	Sn3.0Ag0.5Cu	Sn3.0Ag0.5Cu	Sn0.7Cu	Sn0.7Cu
0,5 mm	T005 13 864 99	T005 13 870 99	T005 13 880 99	T005 13 876 99
0,8 mm	T005 13 863 99	T005 13 869 99	T005 13 879 99	T005 13 875 99
1,0 mm	T005 13 862 99	T005 13 868 99	T005 13 878 99	T005 13 874 99

WTSF 80



Pulsed operation
펄스작동



Normal operation
정상작동

WD 1
WSD 81
WSD 81i
WS 81

1-10

+

UP / DOWN

-

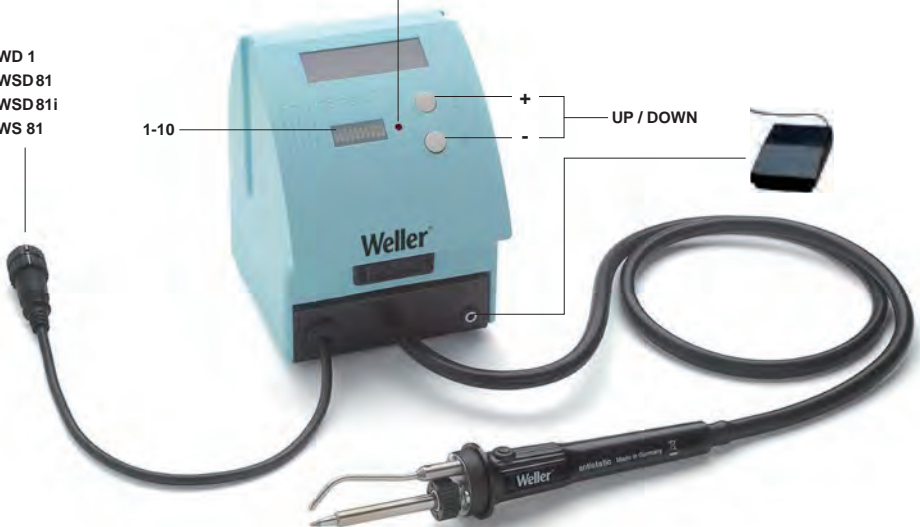

WTSF 120 / WXSf 120



Pulsed operation
펄스작동



Normal operation
정상작동

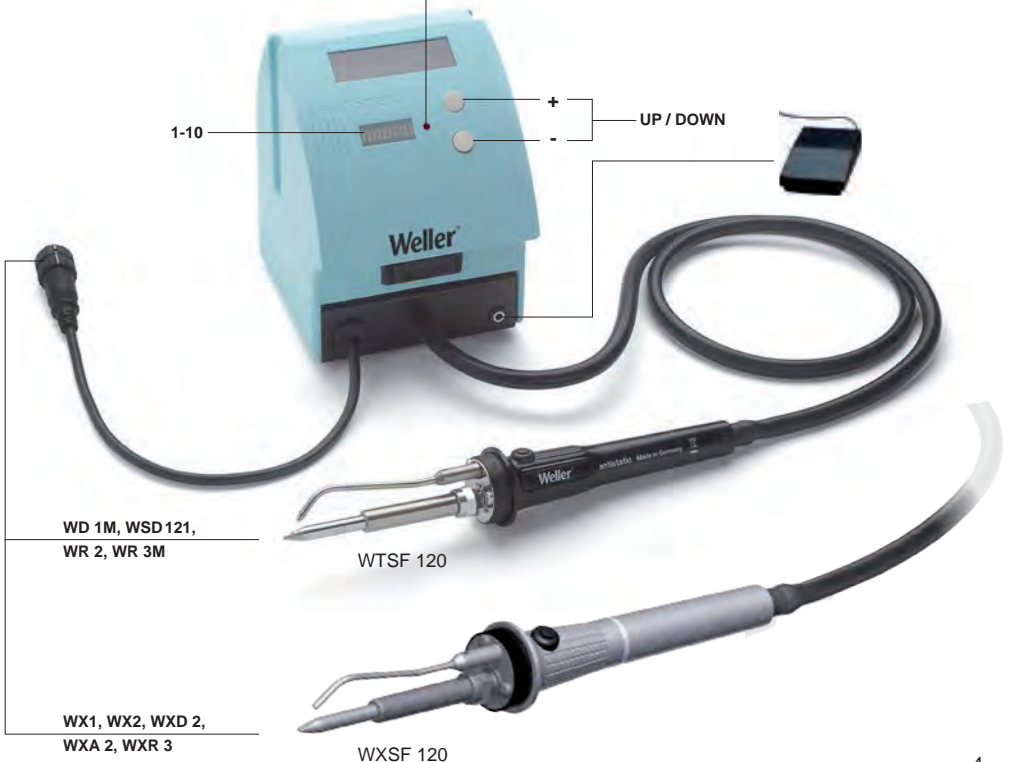



Always place the soldering tool
in the safety rest while

납땀공구를 사용하지 않을 경우,
안전스탠드에 거치하여 주세요.

Starting up the device

시스템 가동

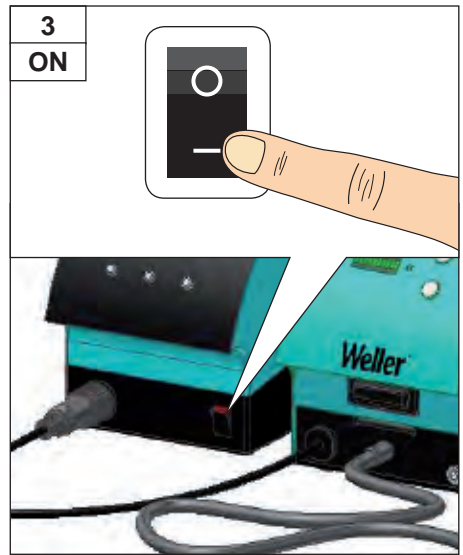
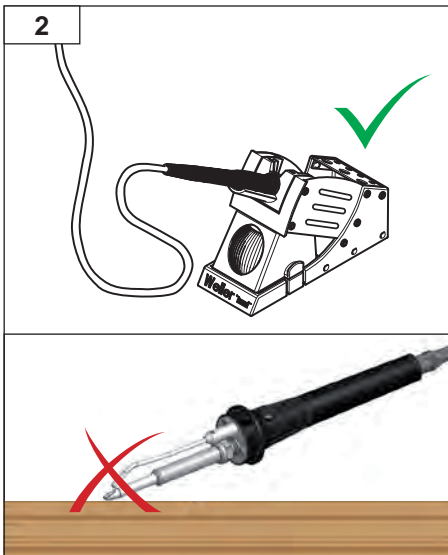

Operation

작동

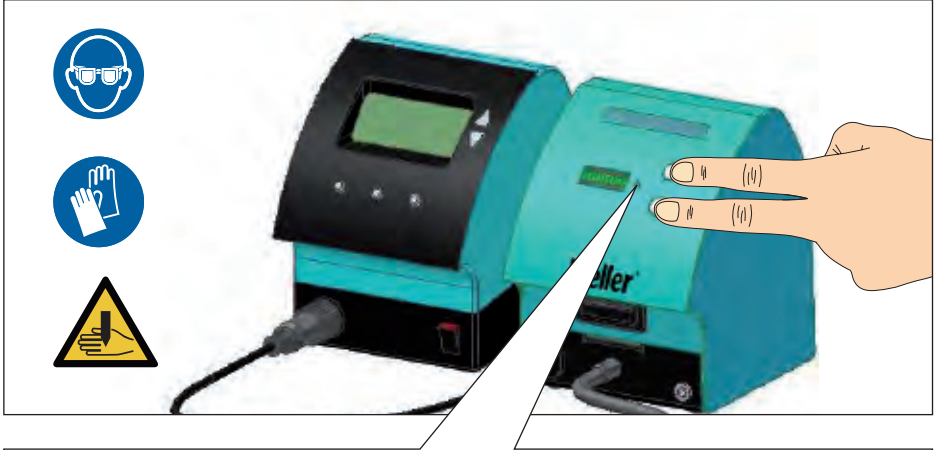

Normal
operation

정상작동



Pulsed
operation

펄스작동

Normal operation

정상 작동

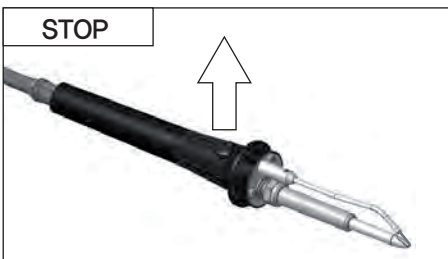
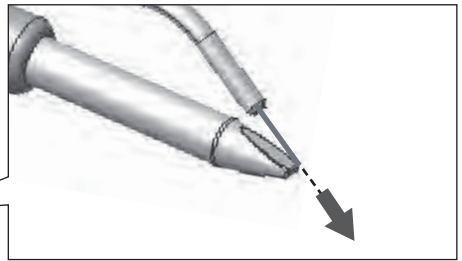
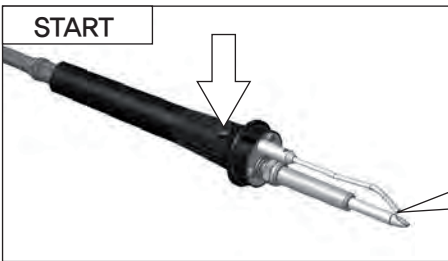
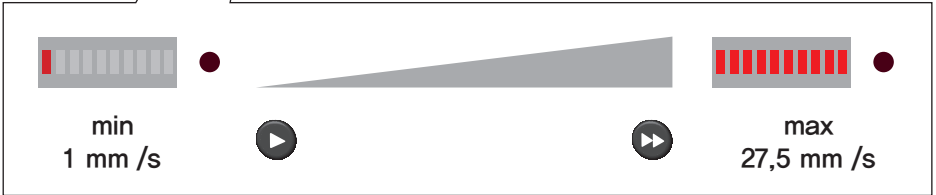
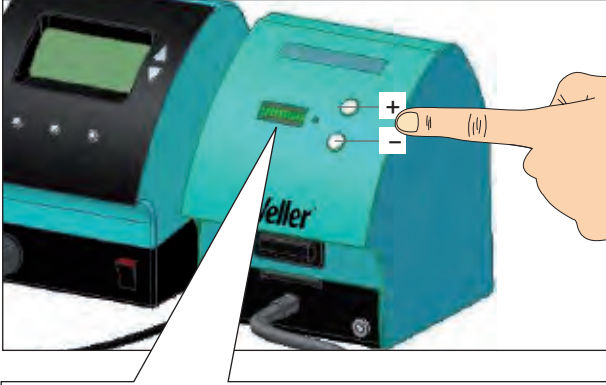

Pulsed operation

펄스 작동

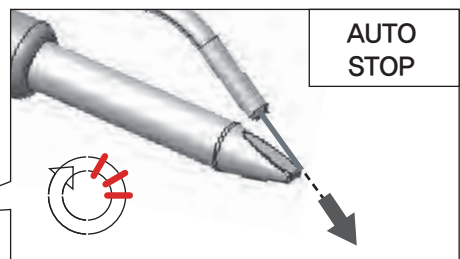
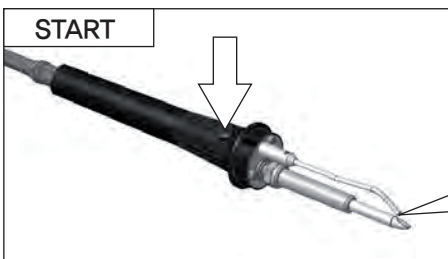
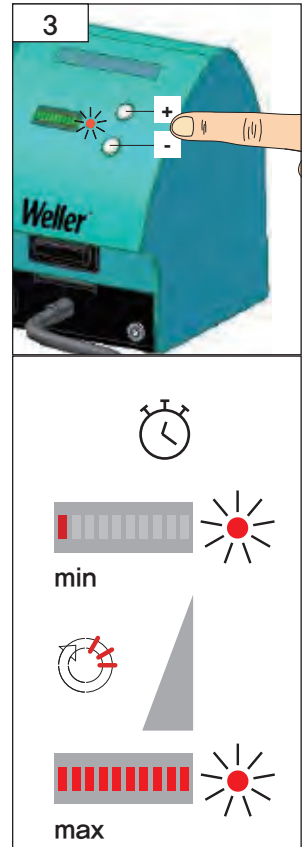
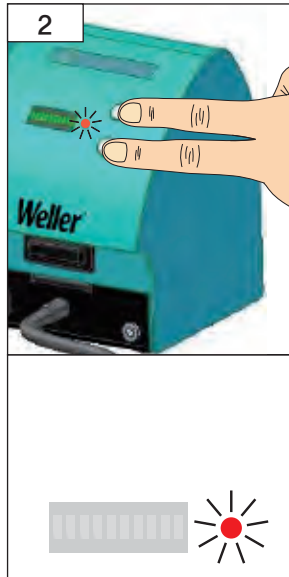
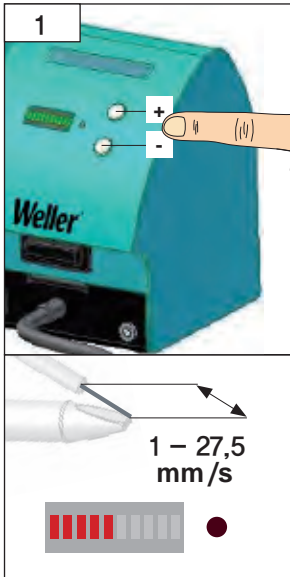

Replace solder wire

솔더 와이어 교체

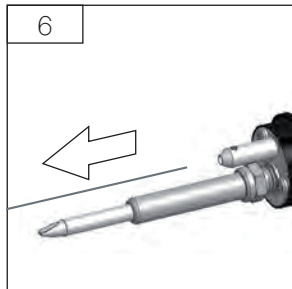
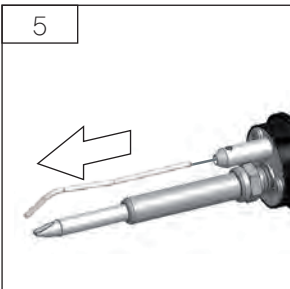
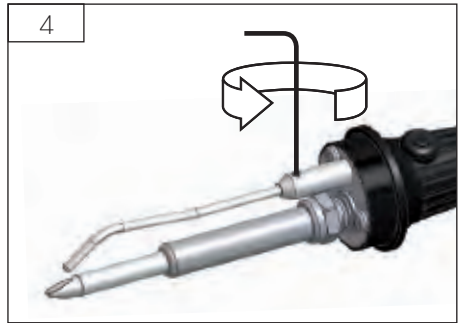
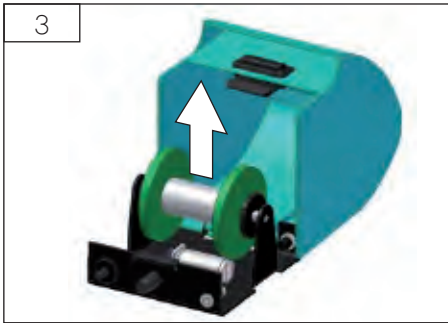
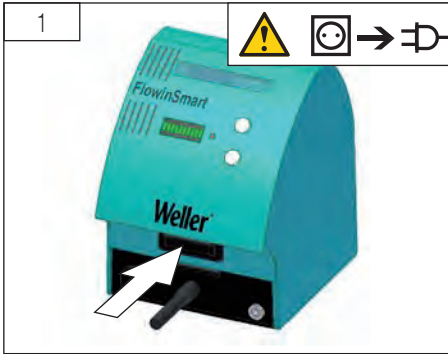
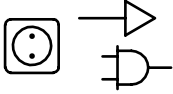

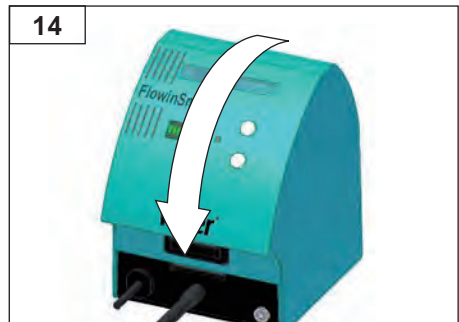
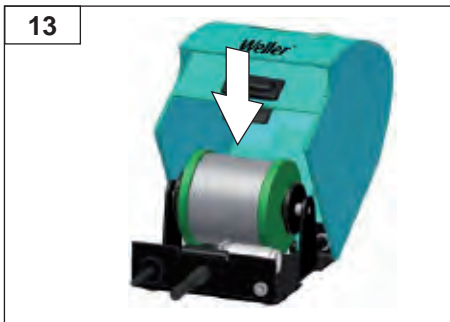
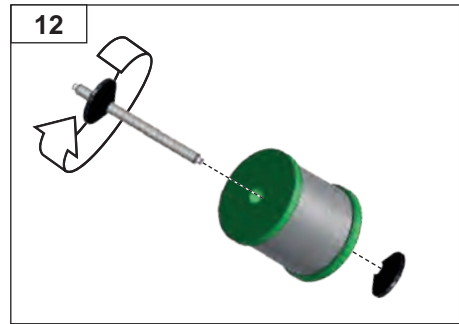
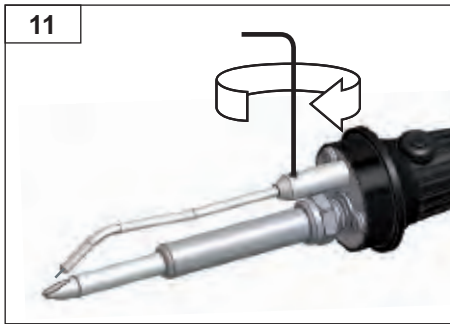
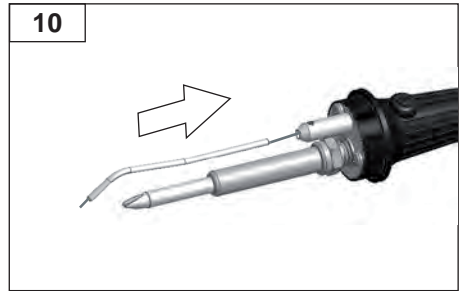
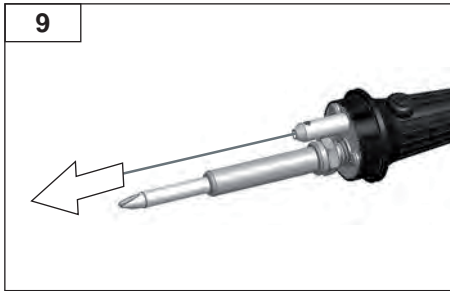
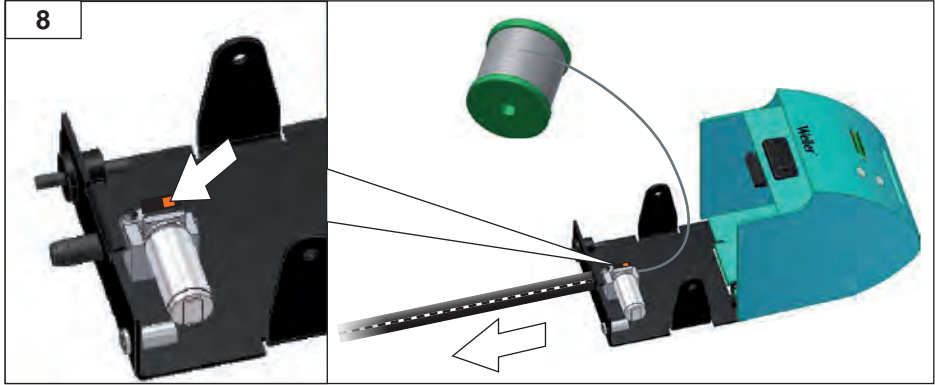

Soldering tip replacement WTSF 80

납땀 팁 교체 WTSF 80

WTSF 80

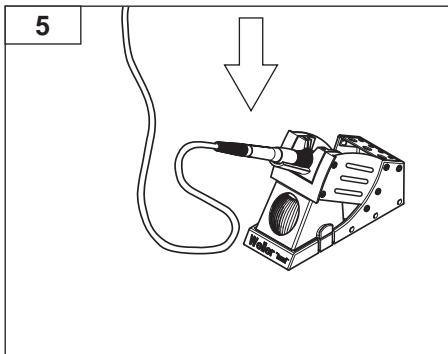
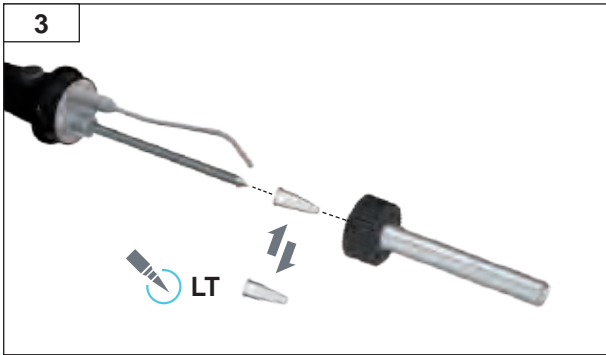
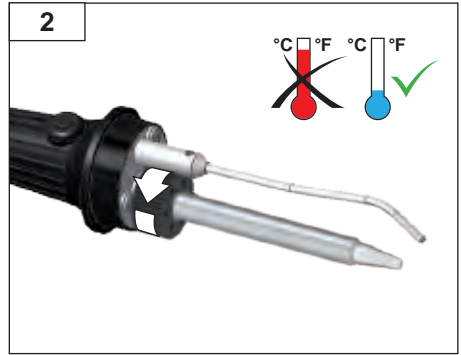
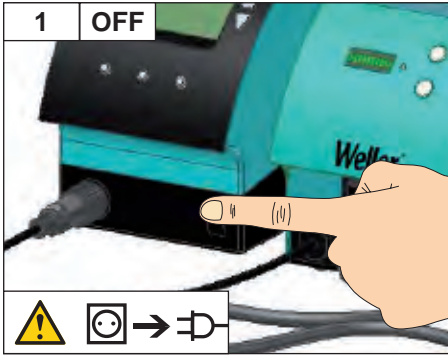

Soldering tip replacement WTSF 120

납땀 팁 교체 WTSF 120

WTSF 120 / WXSF 120

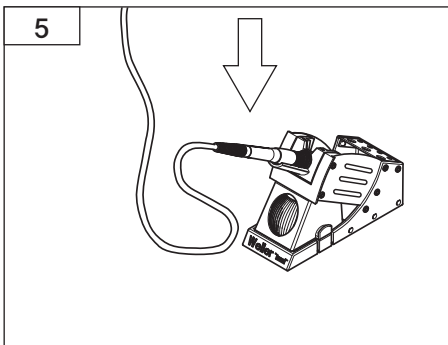
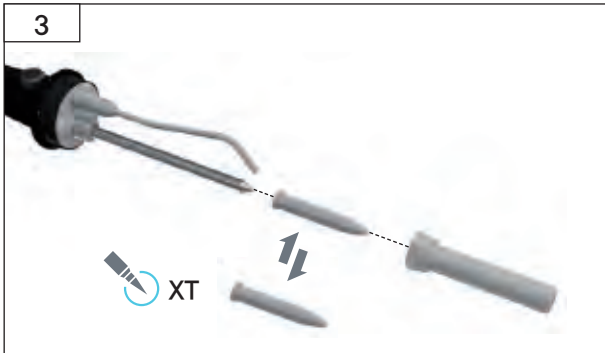
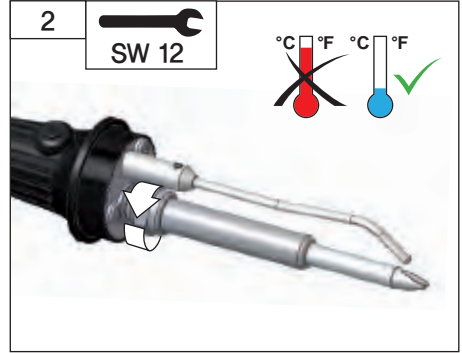
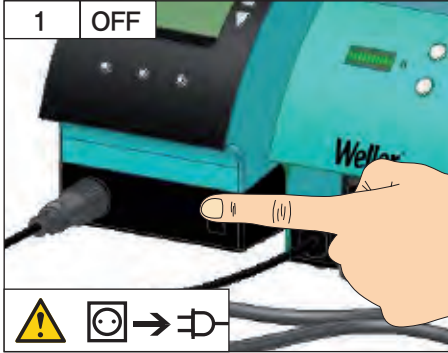

GERMANY

Weller Tools GmbH
Carl-Benz-Straße 2
74354 Besigheim

Tel: +49 (0)7143 580-0
Fax: +49 (0)7143 580-108

ITALY

Apex Tool S.r.l.
Viale Europa 80
20090 Cusago (MI)

Tel: +39 (02)9033101
Fax: +39 (02)90394231

FRANCE

Apex Tool Group S.N.C.
25 Avenue Maurice Chevalier B.P. 46
77330 Ozoir-la-Ferrière Cedex

Tel: +33 (0)1.64.43.22.00
Fax: +33 (0)1.64.43.21.62

GREAT BRITAIN

Apex Tool Group (UK Operations) Ltd
4th Floor Pennine House
Washington, Tyne & Wear
NE37 1LY

Tel: +44 (0) 191 419 7700
Fax: +44 (0) 191 417 9421

KOREA

WellerKorea. Ltd.
3rd Floor, 56, Gwaegam-ro,
Sasang-gu, Busan, Korea

Tel: +82 51-325-0777
Fax: +82 51-325-0776

SWEDEN

Apex Tool Group AB
William Gibsons Vag 1C
43376 Jonsered

Tel: +43 (0) 31-725 6430

SWITZERLAND

Apex Tool Switzerland Sàrl
Crêt-St-Tombet 15
2022 Bevaix

Tel: +41 (0) 24 426 12 06
Fax: +41 (0) 24 425 09 77

USA

Apex Tool Group, LLC
14600 York Rd. Suite A
Sparks, MD 21152

Tel: +1 (800)688-8949
Fax: +1 (800)234-0472

CANADA

Apex Tools – Canada
5925 McLaughlin Rd.
Mississauga, Ontario L5R 1B8

Tel. +1 (905) 501-4785
Fax. +1 (905) 387-2640

AUSTRALIA

Apex Tools
P.O. Box 366, 519 Nurigong Street
Albury, N.S.W. 2640
Australia

Tel: +61 (2)6058-0300
Fax: +61 (2)6021-7403

INDIA

Apex Tool Group India Pvt. Ltd.
Regus business centre
LEvel 2, Elegance, Room no. 214
Mathura Road, Jasola
New Dehli - 110025

CHINA

Apex Tool Group
A-8 building
No. 38 Dongsheng Road
Heqing Industrial Park, Pudong
Shanghai 201201

Tel: +86 (21)60880288
Fax: +86 (21)60880298

SOUTH EAST ASIA

Apex Power Tools India Pvt. Ltd.
Gala No. 1, Plot No. 5
S. No. 234, 235 & 245
India land Global Industrial Park
(Next to Tata Johnson Control)
Taluka-Mulsi, Phase-I
Hinjawadi Pune (411057)
Maharashtra, India
toolsindia@apextoolgroup.com